

Instructions for Pacazur®



VIEW VIDEO INSTRUCTIONS

DANGER

NEVER FORCE OR PRESS TO INTRODUCE THE WASTE WASTE TO BE DISPOSED OF ACCORDING TO REGULATIONS RESPECT THE FILL LIMIT - ONE-WAY CONTAINER, DO NOT REUSE

<http://www.pacazur.fr/downloads/PACAZUR.MP4>

ASSEMBLY

1) Put the lid on the container.

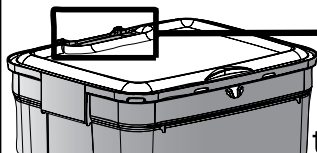

2) Clip the hinge

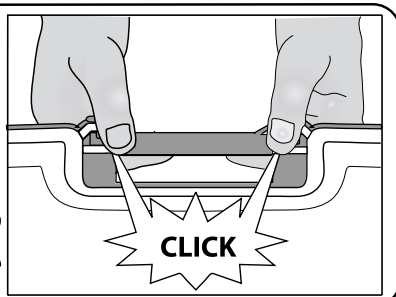

STAND

Assembly :



- 1) Lay down the box with the hinged lid inserted and folded down
- 2) Lift the lid to upright position and insert the upper rod in the small handle

Disassembly : Remove the rod, close permanently the lid and lift up the container to remove it from the stand

PROVISORY CLOSURES

Standard Plain Lid



Temporary closure :

Press down on the lid above the tongue and pinch the wings together to lock the lid.

Unlocking :

Flatten the wings to release the tongue.



Aperture Lid

Position 0 : assembly - press on the plug in ▽ and in ⊙ to insert it.

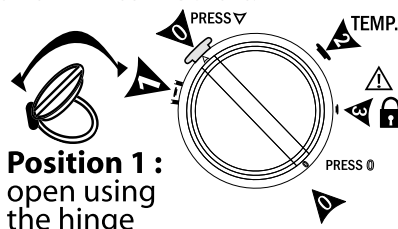

Position 2 :
temporary closure

Position 1 :
open using the hinge

Position 3 :
permanent closure

Do not use the holding device of the small lid in lid to handle the box

PERMANENT CLOSURE

CAUTION :

PRIOR TO ENGAGING THE CLIPS FOR PERMANENT CLOSURE TAKE CARE TO ENSURE THE EDGE/LIP OF THE LID IS LOCATED INTO THE BORDER CHANNEL OF THE VAT, PAY SPECIAL ATTENTION TO THIS PRE-CLOSURE ACTIVITY IF THE VAT HAS BEEN DISTORTED DURING FILLING.

- check that nothing is sticking out of the container,
- to guarantee a leak-proof seal, lid and container edges must be dry when closing

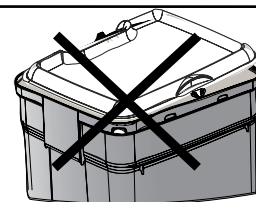

CLIPPING

Snap the edge of the lid & the body together at every clip (11):

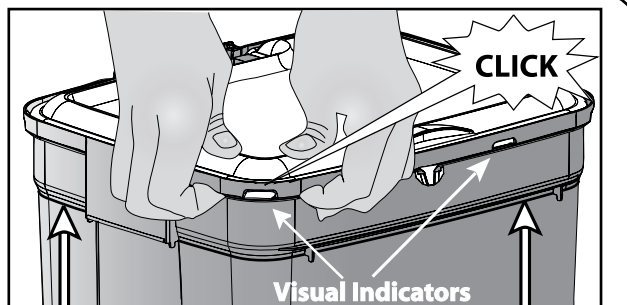
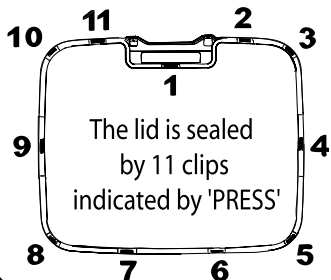

WARNING
DO NOT FILL ABOVE THE LINE

PROTECT YOURSELF FROM MUSCULOSKELETAL DISORDERS

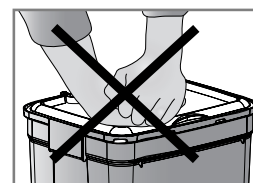

SIMPLY SNAP THE EDGE OF THE LID & THE CONTAINER TOGETHER. IT WILL ALLOW FOR AN EASY AND SECURE CLOSURE

"Instructions for use shall include (...) correct, verifiable closure of the container when the contents have reached the fill line" (ISO 23907)

- count the number of clicks that you hear when closing (press until you hear a click)
- in case of doubts, the locking of a clip can be viewed on the lid and / or in the wholes of the border